

## Preparation

Remove all but the appropriate clamp (*figure 1*) matching the chosen needle size.

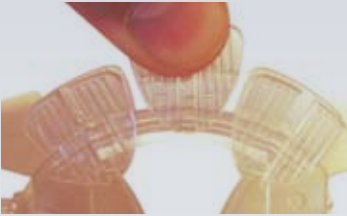

*(figure 1)*  
Remove all but the one clamp matching the selected needle size

## Instruction for use

1) Remove the release liner and place the needle holder centred on the entry point (*figure 2*)

2) Remove the chosen clamp, fit it around the needle (*figure 3*) and press it lightly onto the arch until a click can be heard

3) Move the assembly until the appropriate angle is obtained

*(figure 2)*  
Place the needle holder centred on the entry point

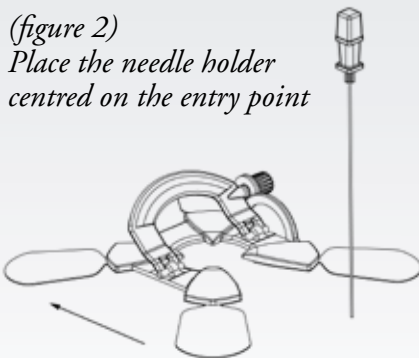

*(figure 3)*  
Fit the clamp around the needle and press down for the first click

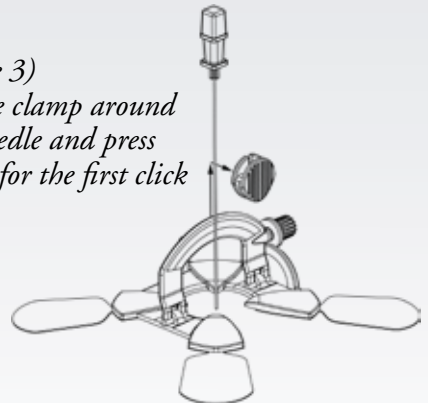

4) Fasten the nut and push down the clamp (*figure 4*) to fixate the needle in the chosen angulations

5) If diagnostic images show a need to re-angle the needle repeat 3 and 4 until the angle to the lesion is correct

6) The needle holder may be used to steer the needle towards the lesion

7) If needed remove the clamp and fold down (*figure 5*) the arch to continue without aid from the Simplify.

*(figure 4)*  
Fasten nut and  
push down clamp  
to fixate the needle

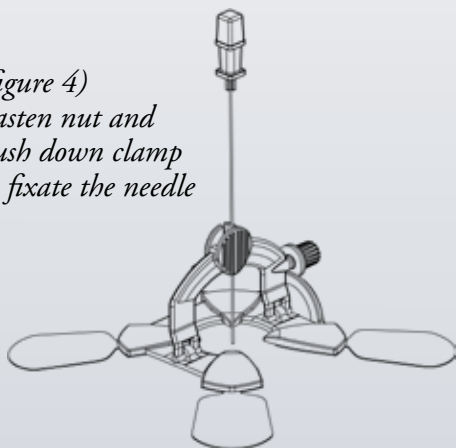

*(figure 5)*  
Remove clamp and  
fold down arch

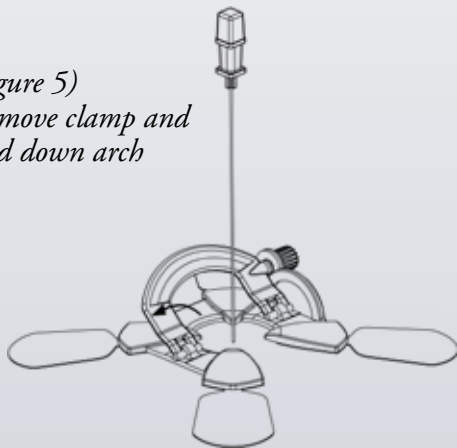

NeoRad AS  
Parkveien 53 B  
0256 Oslo  
Norway

Tel: 24 11 09 80  
Fax: (+47) 24 11 09 51  
Mobile: (+47) 970 65 312  
e-mail: mail@neorad.no